



# PLANTHAVEN RED CARPET DEBUTS



**NEW**

## Abutilon “Lucky Lantern” Series

This series of new compact generic dwarf Abutilons are a complete breeding breakthrough. They have a tight rounded habit, providing perfect support for the outward faced bell shaped flowers. They are quick and easy to grow; needing one pinch of the central stem which will establish the bushy habit, and no further pinching is required. Another point of interest is the quick finish time; from a 72 cell pack to a quart planted in spring takes just 6-8 weeks. The Abutilons have masses of buds and flowers; this has the added advantage of the plants giving a long retail shelf life. With the flowers giving superb coverage of color and having a long blooming season these Abutilons are sure winners. These plants are ideal for many gardening uses and applications. For the future is a stunning bright red which is soon to be added to the series. Watch out for this one so that you can add to the series.

**Hardiness:** USDA Zone 8. (15°F or -12°C).

**Foliage:** Small-medium sized mid green foliage.

**Habit:** Compact tight rounded habit. 12" x 12".

**Culture:** Best grown in well-drained soil in full sun.



**Abutilon Lucky Lantern ‘Tangerine’ Bloom:** Large bell shaped blooms in warm coral peach tones.

**Abutilon Lucky Lantern ‘White’ Bloom:** Large bell shaped blooms in a pure white tone.

**Abutilon Lucky Lantern ‘Yellow’ Bloom:** Large bell shaped blooms in a soft lemon tone.

**Closest Variety:** *A. Bella Series*

**Key Differences:** ✓ Lucky Lanterns vegetatively vs. seed propagated.

✓ Lucky Lanterns long blooming season vs. average season.

✓ Lucky Lanterns compact rounded habit vs. average habit.



### Key Features

- Compact genetic dwarf.
- Large bell shaped blooms.
- Long flowering season.

## *Agapanthus 'Gold Strike'*

This colorful New Zealand selection has fantastic golden and green variegated foliage, topped from mid summer with dainty flower heads made up of deep blue buds opening to elegant picotee blue and white striped individual blooms.

'**Gold Strike**' has wider leaves than other variegated Agapanthus with distinct bright and stable gold margins making a bold statement. A striking specimen, excellent for mass planting in the border with multi-season interest even when not in bloom. A great landscape accent plant.

**Hardiness:** USDA Zones 7-10.

**Bloom:** Dainty flower heads made up of deep blue buds opening to elegant picotee blue and white striped blooms.

**Foliage:** Fantastic gold and green variegated foliage.

**Habit:** Tidy small - medium sized clumping habit. 16" x 16". Flower stem 24".

**Culture:** Best grown in fertile soil in full sun to part shade.



## *Colocasia 'Diamond Head'*

This top performer from the sensational Royal Hawaiian® Colocasia collection boasts foliage of deep plum-purple to chocolate-black color with a glossy sheen and ruffled edges. Deep purple leaves and stems reflect light and shimmer in the summer sun. This variety grows in a nice, mannerly clump up to 4 or 5 feet tall. Leaves will reach 12 to 18 inches across, and they don't fall over in mid-summer like so many other varieties. Colocasias are well suited to a tropical program and with their tidy clumping habit they would be a welcome addition in any garden or landscape.

**Hardiness:** USDA Zones 7b - 11; frost will trigger dormancy.

**Foliage:** Bold and beautiful.

**Habit:** Height ranges from 48" - 60".

**Culture:** Full sun for best color. They prefer rich, moist soil.

Colocasia like wet feet. Burnt leaf edges can be a sign of under-watering. Colocasias prefer warm temperatures. The warmer the better for fast growth.

**UGA Classic City Award 2008**



## **NEW** *Cordyline 'Design-A-Line Burgundy'*

This striking new Cordyline selection has fine burgundy weeping foliage with a tight clump-forming habit normally associated with Phormium and New Zealand Flax. The brilliant foliage is more rigid in the pot than other forms. This quick-growing variety makes a striking impulse plant with a long period of seasonal interest. Great in the garden or as a potted specimen plant. This plant offers good performance year around. It keeps it's color and is tidy of habit with great foliage and a scented flower.

**Hardiness:** USDA Zones 8-11, (10°F or -12°C).

**Foliage:** Fine burgundy colored weeping foliage.

**Bloom:** Fragrant jasmine scented sprays of tiny white star shaped blooms. Mid-late summer.

**Habit:** Tight clumping habit. 3' x 3'.

**Culture:** Well-drained soil in full sun to part shade.





## *Cordyline 'Renegade'*

**Cordyline 'Renegade'** is a striking, unique, new clump-forming Cordyline. This variety is set apart from standard Cordyline selections by its tight, clump-forming habit. The broad, dark purple-black foliage is accented with a glossy lacquered finish. The architectural foliage and tight clumping habit makes **'Renegade'** the perfect choice for the modern garden, containers for the deck or patio, or for commercial landscape work.

**Hardiness:** USDA Zones 8-11.

**Foliage:** Broad, dark purple-black foliage with a glossy iridescent lacquered finish.

**Habit:** Tight clumping habit.

**Culture:** Best in well-drained soil in full sun to part shade.

**American Nurseryman New Plants for 2009 Selection**



## *Dahlia "Mystic" Series*

**NEW**

### *Dahlia 'Mystic Enchantment'*

**'Mystic Enchantment'** is an elegant new Dahlia cultivar from eminent NZ breeder Dr Keith Hammett. **'Mystic Enchantment'** has Keith's trademark filigreed deep mahogany to black foliage. The plants are then topped from early summer with bright fire engine red blooms with elegant dark centers. This selection is the ideal choice for easy care low maintenance modern containers on the deck or patio, or as a medium sized accent plant in the garden / modern landscape.

**Hardiness:** USDA Zones Zone 9-11. (20°F or -6°C). Half hardy.

**Bloom:** Unique fire engine blooms with elegant central dark discs.

**Foliage:** Deep glossy mahogany-black foliage.

**Habit:** Tight clumping habit. Height: 4-7"; Spread: 8".

**Culture:** Full sun, in rich moist well-drained medium.



**NEW**

### *Dahlia 'Mystic Haze'*

**'Mystic Haze'** has been specifically selected from the breeding program of leading New Zealand breeder Dr. Keith Hammett. The single blooms are a striking blend of red, orange and yellow born on dark bronze foliage thus representing the attractive aspects of the sun as well as the negative effects of its radiation. While most single Dahlias have a yellow central disc **'Mystic Haze'** has a dark disc that adds to both the visual appeal and message. The plant is equally suited to being grown in a container or as a feature in the garden.

**Hardiness:** USDA Zones Zone 9-11. (20°F or -6°C). Half hardy.

**Bloom:** Unique sun kissed apricot-orange blooms with soft yellow halo and dark central discs. Early summer- fall.

**Foliage:** Deep glossy mahogany-black foliage.

**Habit:** Tight clumping habit. Height: 4-7"; Spread: 8".

**Culture:** Full sun, in rich moist well-drained medium.

**NEW**



## Whetman Pinks *Dianthus "Early Bird"™ Series*

Whetman®'s new range of Early Bird™ Dianthus start flowering at the end of February or the beginning of March, depending on your location, and if you remove the spent blooms, they will continue to rebloom right through to fall. They make excellent subjects for window boxes, baskets or planters.

**Dianthus Early Bird™ 'Chili'**: Bold electric pink double flowers are carried on sturdy stems. This color is a great addition to the range.

**Dianthus Early Bird™ 'Fizzy'**: An explosion of pale lavender petals with serrated edges and deep purple centers. Wonderfully perfumed. Very long-flowering.

**Dianthus Early Bird™ 'Frosty'**: Wonderfully fragrant large double blooms, pure white in color carried on sturdy stems.

**Dianthus Early Bird™ 'Radiance'**: Fully double crimson red blooms on a well balanced plant. Very early blooming.

**Dianthus Early Bird™ 'Sherbet'**: Large magenta fully double flowers on a compact plant.

**Hardiness:** USDA Zone 5. (-20°F or -28°C). Currently testing.

**Foliage:** Glaucous, blue green foliage.

**Habit:** Tight compact mounding habit.

**Culture:** Plant in a well-drained soil in sun.



**Dianthus Early Bird™ 'Chili'**



**Dianthus Early Bird™ 'Fizzy'**



**Dianthus Early Bird™ 'Frosty'**



**Dianthus Early Bird™ 'Radiance'**



**Dianthus Early Bird™ 'Sherbet'**



## *Dianthus "Scent First"™ Series*

The Whetman® "Scent First"™ Series is characterized by its delightfully spicy fragrance, compact free flowering habit, silver-blue foliage, and lengthy blooming periods. Ideal for larger pots and containers and lovely cut flowers.

**'Candy Floss':** Sugar pink and beautifully perfumed. Approximate flowering height 11". A great variety for patio planters where you can enjoy the perfume on warm summer evenings. Early blooming.

**'Eternity':** Highly fragrant semi double blooms, rose pink in color with a darker eye, carried on sturdy stems. Repeat blooming.

**'Passion':** What better gift for Valentine's Day than a Dianthus named 'Passion'! Early blooming, it makes a great potted plant gift and seasonal color extender.

**'Tickled Pink':** Deep lavender with a wonderful strong spicy perfume flowering over a long period. Great for patio containers, planters, window boxes or the front of a garden border. Flowering height approximately 9". Mid-season blooming.

**Hardiness:** USDA Zone 5. (-20°F or -28°C).

**Bloom:** Delightful spicy fragrance, bright colorful double blooms carried on sturdy stems.

**Foliage:** Glaucous, blue green foliage.

**Habit:** Tight compact mounding habit 11" x 11".

**Culture:** Plant in a well-drained soil in sun.

**Royal Horticultural Society Award of Garden Merit**

**NEW**



**Dianthus Scent First™ 'Candy Floss'**



**Dianthus Scent First™ 'Eternity'**



**Dianthus Scent First™ 'Passion'**



**Dianthus Scent First™ 'Tickled Pink'**



## Whetman Pinks *Dianthus* "Surprise"™ Series

**NEW**

These compact, long-blooming, hardy *Dianthus* have exceptional habit, forming dense mounds of foliage. Beginning in spring, they are smothered with fragrant, double blooms with burgundy red centers on short stems. Plants can continue flowering into fall. These cultivars produce a gorgeous, uniform gallon crop due to their great habit, vigor, and abundant bloom. Flower stems are sturdy and short, and do not flop. They will perform well in rockeries, borders, or in containers. Re-blooming. No vernalization required.

**'Coconut Surprise':** Masses of fragrant, double, white blooms with burgundy red centers carried on short stems. Flower stems are short and sturdy and do not flop. Attracts bees and butterflies. **'Coconut Surprise'** produces a gorgeous, uniform gallon crop due to its great habit and vigor and abundant bloom.

**'Raspberry Surprise':** The epitome of traits Whetman® Pinks breeds for: scent, great color combination, and superb habit. While most *Dianthus* offer just one bloom per stem, **'Raspberry Surprise'** gives you anywhere from 2 to 5 – a nosegay on every flowering stem! Excellent for pot production, they may be forced, plus they are hardy! Retailers will love them for a fragrant head turning mass or end cap impulse display item.

**Hardiness:** USDA Zone 5. (-20°F or -28°C).

**Foliage:** Fine and generally glaucous.

**Habit:** Height: 10"-12" in full flower.

**Culture:** Full sun, well-drained soil.



**Dianthus 'Coconut Surprise'**



**Dianthus 'Raspberry Surprise'**



## Whetman Pinks *Dianthus* "Star"™ Series

### *Dianthus 'Pop Star'*

This new selection from the breeder of the "Star" series has double bloom appeal. This variety produces attractive deeply fringed double pink flowers with a cherry eye from mid to late summer. The spicy scented flowers are 1" – 1.5" diameter, held 3" above foliage that forms a tidy compact blue-green mound. Day neutral, with perpetual flowering, they are heavily budded in spring. Vernalization is not necessary.

**Dianthus 'Pop Star'** is a perfect addition to alpine gardens, rockeries, and for use as a front of the perennial border or in mixed containers.

**Hardiness:** USDA Zone 4.

**Foliage:** Fine and generally glaucous.

**Habit:** Tight clumping habit. Height: 4-7", Spread: 8".

**Culture:** Plant in a well-drained soil in sun.





## **NEW** *Erysimum 'Fragrant Star'*

'**Fragrant Star**' is a lovely, variegated more compact sport of the popular variety 'Fragrant Sunshine'. This shining star glows with bright sunshine yellow blossoms and radiant, variegated green and yellow foliage. Flowers are produced over a long season – an attribute resulting from its sterile nature. Flowers are sweetly scented and buds arise chocolate-purple in color. Walberton's® '**Fragrant Star**' is very compact with dense bushy growth. A splendid patio container plant, it can also be used in the perennial border, or as a bedding plant in colder districts.

**Hardiness:** USDA Zone 7. (-0°F or -17°C).

**Bloom:** Bright sunshine yellow sweetly scented sterile bloom. Early spring - summer.

**Foliage:** Elegant cream and silver green variegated foliage.

**Habit:** Compact mounding habit 18" x 24".

**Culture:** Full sun to part shade, in fertile well-drained soil.



## *Euphorbia 'Ascot Rainbow'*

'**Ascot Rainbow**' has been selected for its distinct and unique variegated flowers and foliage. The flower color consists of cream, lime, and green while the foliage displays tones of cream, green/blue with stunning red-pink coloring throughout cooler months. One of the major benefits of this selection is extreme tolerance to heat and dryness. Growers: it is easy to root and grow! With no known pests or diseases and stunning foliage color throughout the year '**Ascot Rainbow**' is an excellent performer for the modern garden and landscape. "It's all about the foliage – it rocks!"

**Hardiness:** USDA Zone 7 possibly 6.

**Bloom:** Unique tubular flowers: Cream, lime and green.

**Foliage:** Leaves are variegated cream and bluish green.

**Habit:** Compact and slightly spreading. Height: 20" x 20".

**Culture:** Full sun.

**American Nurseryman New Plants for 2009 Selection**



## *Euphorbia 'Ruby Glow'*

'**Ruby Glow**' has a great habit, is very branched and compact with stunning ruby red foliage in the fall and virtually black leaves in winter in the UK. New foliage is an attractive red. In late March through May, the 18" tall clumps are topped with 6" tall x 3" wide alien antennae-like flower heads of bright yellow. '**Ruby Glow**' can be used as an ornamental plant in gardens and containers for its eye-catching appearance and flowers. As with most Euphorbias, good drainage is very important and be sure to cut the plant back hard after flowering to rejuvenate the new basal growth. '**Ruby Glow**' is a striking impulse plant with a long period of seasonal interest.

**Hardiness:** Zones 6-11. (-10°F or -23°C).

**Bloom:** Masses of fresh apple green bracts. Early summer - fall.

**Foliage:** Unique ruby red new foliage with contrasting bright cherry red stems.

**Habit:** Squat compact-spreading habit. 16" x 20".

**Culture:** Well-drained soil in full sun.

**NEW**

## *Gaillardia 'Fanfare Blaze'*

'**Fanfare Blaze**' is the first in the new Fanfare breeding program, and has all the standout features from the team who brought you the benchmark selection G. 'Fanfare' – unique pinwheel blooms, compact tight habit, exceptionally long flowering period, Early spring– fall. Zone 5 hardy.

'**Fanfare Blaze**' brings all this plus the new color palette to the garden with unique blooms in warm burnt orange tones. A real sun lover, Drought tolerant once established. Unsurpassed performance in containers, beds, borders. A star of the future.

**Hardiness Estimate:** USDA Zone 5-9. (-20°F or -28°C). Currently testing.

**Bloom:** Unique pinwheels of warm-orange tubular blooms.

**Foliage:** Fresh gray green hairy foliage.

**Habit:** Compact mounding habit 12" x 18"

**Culture:** Full sun, well-drained soil.



**NEW**

## *Gaura 'Passionate Rainbow Petite'*

'**Passionate Rainbow Petite**' is quicker growing than 'Passionate Rainbow' with a tighter growing dense compact mounding habit. The strong cream/green variegation is highlighted by stunning pink flowers which are massed over many months. The foliage color turns a truly amazing burgundy/red through the cooler months and makes a stunning display even when not in flower. Excellent garden performance with an exceptionally long flowering period.

'**Passionate Rainbow Petite**' is better for small pots with excellent shelf life on the retail bench and does not get tall and unsightly. Drought tolerant once established, and ideal for the landscape, containers, beds, and borders.

**Hardiness:** USDA Zone 7. (-0°F or -17°C).

**Bloom:** Dark pink bud opening to medium pink blooms. Early summer – fall.

**Foliage:** Mid green foliage with a fine cream margin blush pink-red early in the season, held on hot red stem.

**Habit:** Tightest growing compact mounding habit 18" x 20".

**Culture:** Full sun, well-drained soil.



## *Geranium 'Crystal Rose'*

'**Crystal Rose**' exhibits all the long-blooming and carpeting characteristics of the parent plant 'Westray'. The near-sterile flowers, which are bright and good sized, are long lasting and profuse appearing throughout the year with the main flush in the warmer months. They are held erect above the foliage, which achieves a moderately dense 12-inch diameter during the first growing season. '**Crystal Rose**' is a versatile landscape plant, worthy of inclusion in the border, or in a rock garden or ground cover situation. Ideal for frost prone areas and also performs well in light shade. '**Crystal Rose**' is drought tolerant once established and requires only occasional good soaks during periods of long hot weather.

**Hardiness:** USDA Zones 5-9.

**Bloom:** Strong, mid-pink flowers on stems of 8-10". Near-sterile.

**Foliage:** Dense, semi-evergreen, with an orangey tint in the fall.

**Habit:** 12" x 12".

**Culture:** Tolerates dry conditions, full sun to partial shade.





## **NEW** *Phormium 'Jubilee'*

**Phormium 'Jubilee'** is a New Zealand Flax cultivar that grows to 3'. Long arching upright leaves have a green center and striking cherry red foliage margins on the upper surface and are entirely red below. **'Jubilee'** displays a very interesting stronger color combination than the parent plant, P. 'Jester'. Plants will exhibit best color when grown in part shade and fed weekly with a well balanced fertilizer high in trace element. It can tolerate fairly dry conditions (coastal) but looks best with occasional to regular irrigation. Excellent impulse line.

**Hardiness:** USDA Zone 8. (15°F or -12°C).

**Bloom:** Foliage selection. No bloom recorded to date.

**Foliage:** Striking cherry red foliage margins to the fresh green foliage.

**Habit:** Tight clumping habit. Foliage is upright-arching. 48" x 72".

**Culture:** Best grown in part shade in fertile soil.



## **NEW** *Sedum 'Elsie's Gold'*

A total show stopper! **Sedum 'Elsie's Gold'** is a beautiful light yellow and green sport from 'Herbstfreude' (Autumn Joy). Attractive toothed silvery green foliage with warm golden yellow leaf margins, fading to a soft creamy white by autumn. By far the most important attribute of **'Elsie's Gold'** is that it is much more stable than the other variegated sedums in commerce. Large flat heads of small star shaped flowers open soft shell pink aging to deep magenta by late autumn. Dried flower heads are excellent for winter garden accents or dried bouquets. Ideal in the stylish modern garden border. **'Elsie's Gold'** is winter hardy.

**Hardiness:** USDA Zone 3-9. (40°F or -40°C).

**Bloom:** Soft shell pink aging to deep magenta. Long summer – fall blooming period.

**Foliage:** Large toothed foliage with warm golden yellow leaf margins, fading to a soft creamy white by fall.

**Habit:** Compact clump forming habit 12" x 12".

**Culture:** Full sun, well-drained soil.



## **NEW** *Tibouchina 'Groovy Baby'*

This compact genetic dwarf has been selected as part of a breeding program and has been bred for long flowering season and exceptional flower power. Masses of red buds opening to large single vibrant violet blooms. Flowers are larger in size and number and exceptionally outward facing, which makes it a high impact plant at retail. Plant habit is very compact and dense. High cutting yield. All of the above combined with more cold tolerance than normal Tibouchina. Heat and drought tolerant once established. Great for containers, borders and the modern landscape.

**Hardiness:** Zone 10. (35°F or -1°C).

**Bloom:** Large single vibrant violet blooms with masses of red buds. Summer-fall. (Long Blooming Season).

**Foliage:** Small sized ribbed foliage.

**Habit:** Extremely compact rounded habit. 1.5' x 1.5'.

**Culture:** Best grown in well-drained soil in full sun. Trim back when young and after blooming to encourage strong basal branching and re-blooming.

# PlantHaven Sun Lovers

## Plants for Hot & Dry Conditions

PlantHaven is pleased to showcase a group of crops specially adapted for gardens / containers in hot and dry areas, sun lovers or xeriscape plants. (Xeriscape pronounced z-eri-scape" is a compound of the Greek xeros, dry, and "-scape," as in landscape, "xeriscape").

Low water usage is a key trend in many landscapes today. Industry professionals and designers are selecting plants based on their low water requirements; creating planters / gardens better equipped to withstand low water, drought conditions.

**PlantHaven Sun Lovers showcased in our display include:**

- ❶ Abutilon Lucky Lantern 'Tangerine'
- ❷ Carex 'Rekohu Sunrise'
- ❸ Caryopteris 'Hint of Gold'
- ❹ Euphorbia 'Ascot Rainbow'
- ❺ Euphorbia 'Blue Haze'
- ❻ Euphorbia 'Glacier Blue'
- ❼ Euphorbia 'Ruby Glow'
- ❽ Gaillardia 'Fanfare'
- ❾ Oenothera 'Shimmer'
- ❿ Salvia 'Ultra Violet'

### Key Features

- Low water use.
- Drought tolerant once established.
- Designed to cope in high sun/heat areas.



# PlantHaven Shrub Program



PlantHaven is pleased to launch five outstanding Berberis varieties from Michal Andrusiv in the Czech Republic. All five varieties have been trialed extensively throughout the U.S. and have performed exceptionally well in all climate zones. As with all new barberries, the varieties were held in quarantine for wheat rust testing at the USDA Cereal Disease Laboratory in Minnesota for more than 2 years and were found to be rust resistant.



**Berberis 'Admiration'**

**Berberis Admiration:** Vibrant flaming coral-red foliage with bright golden yellow leaf margin. Compact rounding habit 1-2' x 1-2' in 5 years (ultimately 2' x 2' untrimmed).

**Berberis Golden Rocket:** Fresh chartreuse foliage with contrasting coral colored stems. Unique tight columnar habit, ultimately 4' in H.

**Berberis Orange Rocket:** Vibrant coral-orange new foliage aging to mid green. Best foliage color when grown in full sun. Unique tight columnar habit, ultimately 4' H.

**Berberis Rosy Rocket:** Fine new young foliage is variegated in soft flamingo pink and burgundy tones held on slender coral stem giving a firework like effect. Tight columnar habit, ultimately 4' H.

**Berberis Tiny Gold:** Bright sunshine yellow foliage. Tight compact rounded habit. 1-2' x 1-2' in 5 years (Ultimately 2' x 2' untrimmed).

These exciting plants will be available exclusively from members of the PlantHaven Shrub Program. For more information on the program please contact Keith Manbeck, Shrub Program Manager, email [keith.manbeck@planthaven.com](mailto:keith.manbeck@planthaven.com)



**Berberis 'Golden Rocket'**



**Berberis 'Orange Rocket'**



**Berberis 'Rosy Rocket'**



**Berberis 'Tiny Gold'**

# PlantHaven Trees

## *Cercis 'Merlot'*

'Merlot' is a *Canadensis* and *texensis* cross to produce a more drought and heat tolerant tree. It has glossy, small rounded dark purple leaves and has an upright vase shaped growth habit. It has a tighter, denser habit than *Cercis 'Forest Pansy'* and is more heat tolerant and drought tolerant (*texensis* factor.) Mature plants flower heavily with strong bright pink flowers that are self-cleaning, and have a low seed set. 'Merlot' does not show leaf stress in heat.

**Hardiness:** USDA Zone 6. (-10°F or -23°C).

**Bloom:** Reddish-purple flowers borne on bare stems in early spring.

**Foliage:** Deciduous, large rounded glossy dark purple foliage.

**Habit:** Semi-upright vase shaped habit. 12' x 15'. The perfect tree for small yards.

**Culture:** Best grown in full sun in well drained soils.



## *Cercis 'Ruby Falls'*

*Cercis 'Ruby Falls'* is a highly attractive weeping form of *Cercis canadensis* with large heart shaped purple leaves. It is the first weeping purple redbud developed. It has attractive dark rose purple flowers. 'Ruby Falls' demonstrates excellent branching with a full crown of foliage at the top. It is an excellent small tree for lawns, as a garden specimen, for woodland gardens or naturalized areas and landscape plantings. 'Ruby Falls' is effective planted as a specimen or in groups. Requires minimal pruning.

**Hardiness:** USDA Zone 6. (-10°F or -23°C).

**Bloom:** Intermediate reddish-purple flowers borne on bare stems in early spring. Profuse flowering and low pod set.

**Foliage:** Deciduous, large heart shaped deep purple foliage.

**Habit:** Elegant weeping habit. 6' x 4'. The perfect weeping tree for small yards.

**Culture:** Best grown in full sun in well drained soils.



## *Styrax 'Fragrant Fountain'*

'Fragrant Fountain' offers significant improvements over existing weeping snowbells! As compared to 'Carillion', 'Fragrant Fountain' maintains a central leader and is a vigorous grower. Masses of strongly fragrant pure white blooms appear in spring. This selection has tolerated temperature extremes ranging from 115 degrees to no damage from the early frost in Oregon in 2002. It's compact habit makes it the perfect tree for smaller yards.

**Hardiness:** USDA Zone 5. (-20°F or -28°C).

**Bloom:** Masses of strongly fragrant pure white blooms. Early spring-summer; repeat blooming mid/late summer where conditions are not too dry.

**Foliage:** Deciduous, glossy dark green foliage, coloring to golden yellow in fall.

**Habit:** Vigorous weeping habit. 6' x 5'.

**Culture:** Best grown in sun-part shade in fertile well drained soils.



**Best of Show and Best new tree Farwest 2008**

# *Mixed Containers*

- ❶ Styrax 'Fragrant Fountain'
- ❷ Carex 'Rekohu Sunrise'
- ❸ Euphorbia 'Glacier Blue'
- ❹ Abutilon Lucky Lantern 'White'
- ❺ Dianthus Early Bird™ 'Frosty'
- ❻ Gardenia 'Crown Jewel'



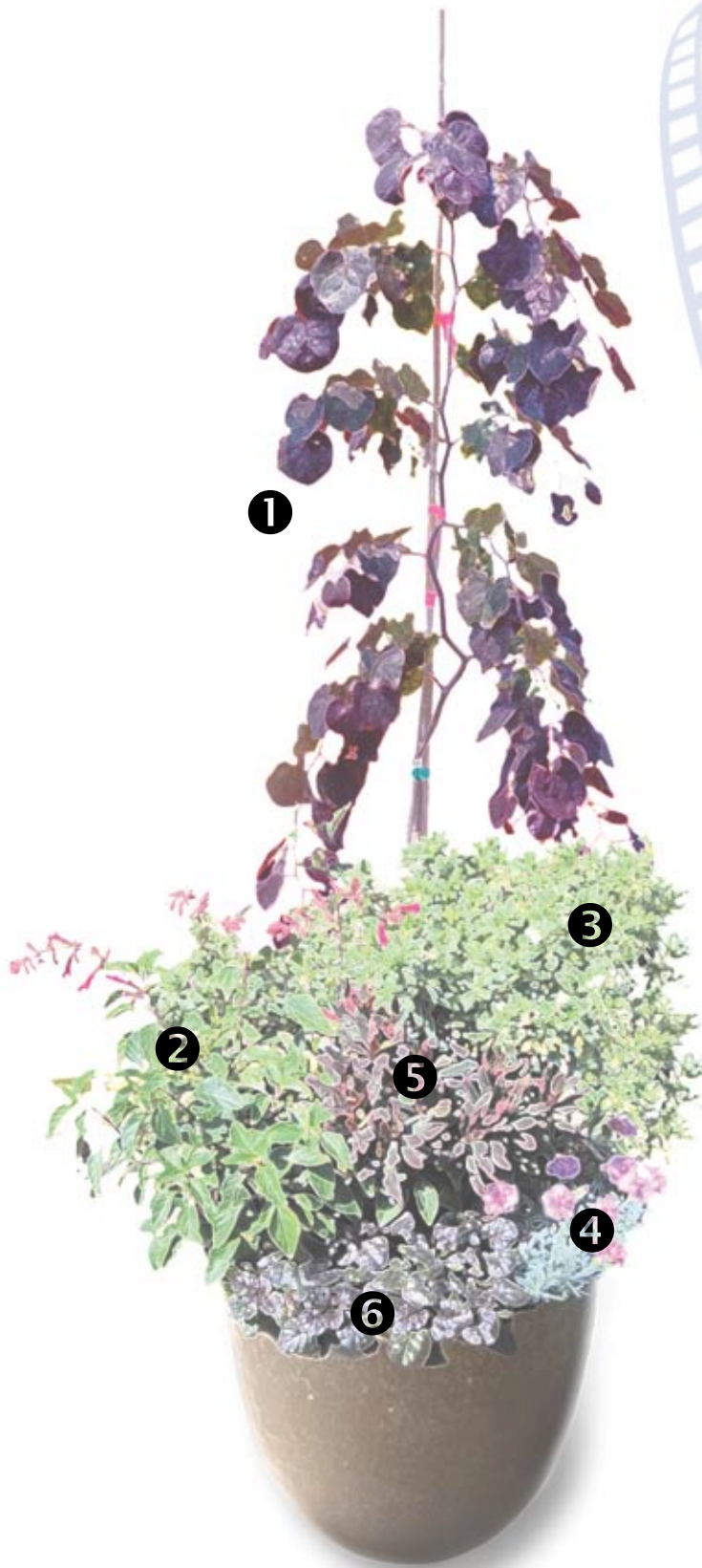



- ❶ Cercis 'Ruby Falls'
- ❷ Salvia 'Wendy's Wish'
- ❸ Daphne 'Eternal Fragrance'
- ❹ Dianthus Star™ 'Pop Star'
- ❺ Euphorbia 'Ruby Glow'
- ❻ Ajuga 'Black Scallop'

# *Mixed Containers*

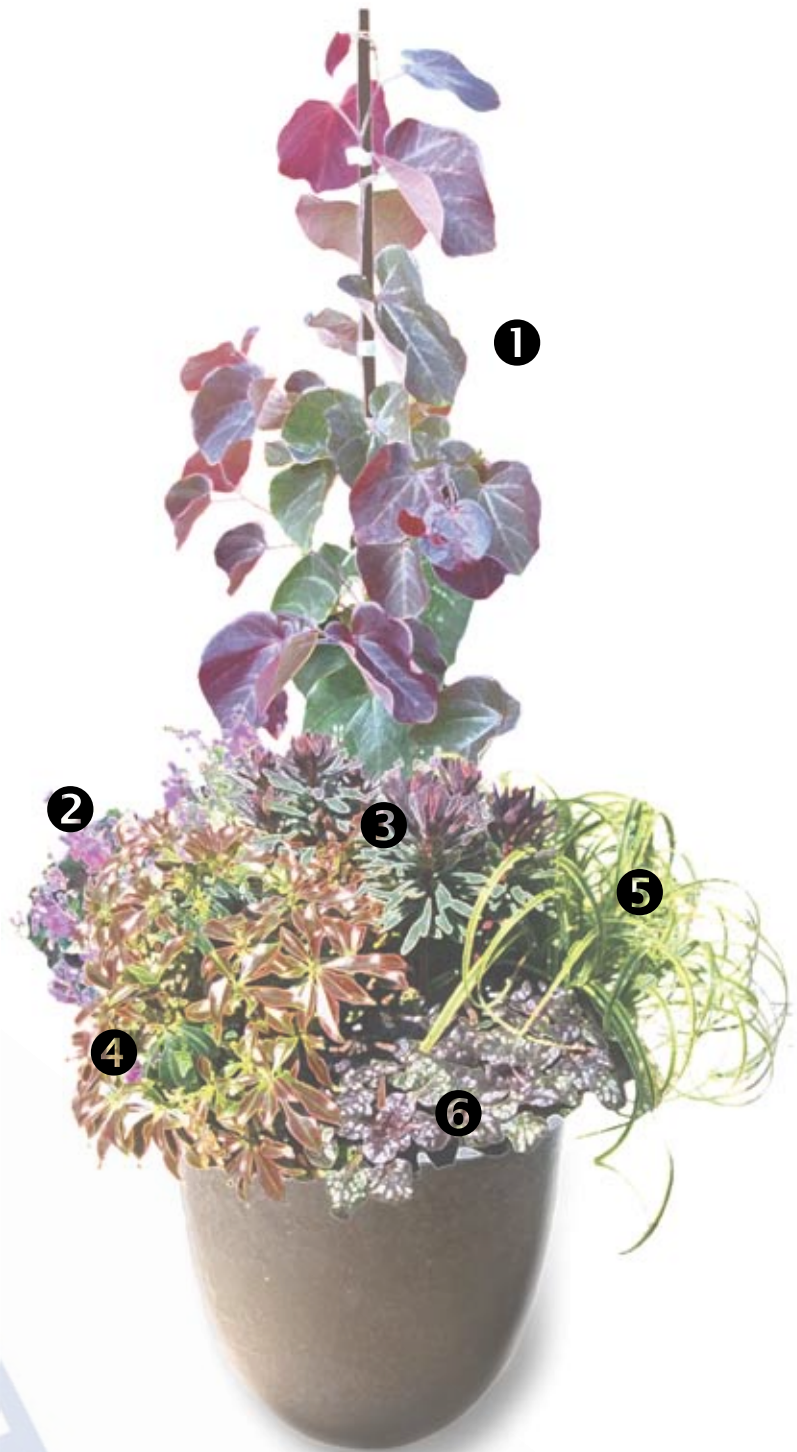
- ❶ Cercis 'Merlot'
- ❷ Salvia 'Ultra Violet'
- ❸ Euphorbia 'Blackbird'
- ❹ Pieris 'Katsura'
- ❺ Carex 'Rekohu Sunrise'
- ❻ Ajuga 'Black Scallop'



- 
- ❶ Cordyline 'Renegade'
  - ❷ Gaillardia 'Fanfare'

❶

❷

# PlantHaven Variety Guide - 2010

Variety	Zone	Patent	Royalty	Uses	Availability	Pot Size	Approx. Finish Times
Abutilon Lucky Lantern Tangerine ('#7')	8	PPAF	\$0.15	Pots & containers, garden border, modern landscape.	URCs, plug/liner	Qt, GL, larger	6-8 weeks (Qt) 10-12 weeks (GL)
Abutilon Lucky Lantern White ('Abut602')	8	PPAF	\$0.15	Pots & containers, garden border, modern landscape.	URCs, plug/liner	Qt, GL, larger	(see above)
Abutilon Lucky Lantern Yellow ('Abut603')	8	PPAF	\$0.15	Pots & containers, garden border, modern landscape.	URCs, plug/liner	Qt, GL, larger	(see above)
Agapanthus 'Gold Strike'	7	20,650	\$0.25	Pots & containers, garden border, modern landscape.	Divisions/ Liners	GL, larger	24-36 weeks (GL)
Colocasia 'Diamond Head'	7b	19,939	\$0.55	Large pots & containers, garden border, pool side plantings	TC/Plug's/ Liners	GL, larger	10-12 weeks (GL)
Cordyline 'Design a Line Burgundy'	8	PPAF	\$0.25	Pots & containers, garden border, modern landscape.	TC/Plug's/ Liners	QT, GL, larger	12-16 weeks (Qt) 20-24 weeks (GL)
Cordyline Renegade ('Tana')	8	18,605	\$0.25	Pots & containers, garden border, modern landscape.	TC/Plug's/ Liners	QT, GL, larger	12-16 weeks (Qt) 20-24 weeks (GL)
Dahlia Mystic Enchantment ('Another Pet')	9	Rights Asserted	\$0.10	Pots & containers, garden border, modern landscape.	TC/Plug's/ Liners	QT, GL, larger	6-8 weeks (Qt) 10-12 weeks (GL)
Dahlia Mystic Haze ('Dark Side of the Sun')	9	Rights Asserted	\$0.10	Pots & containers, garden border, modern landscape.	TC/Plug's/ Liners	QT, GL, larger	6-8 weeks (Qt) 10-12 weeks (GL)
<b>Dianthus "Early Bird"™ Series</b>							
Dianthus Early Bird™ Chili ('WP10 SAB06')	Est. 5 Testing	Rights Asserted	\$0.08	Containers, borders, mass landscape planting.	Plug/liner	Qt	10-16 weeks (Qt)
Dianthus Early Bird™ Fizzy ('WP08 VER03')	Est. 5 Testing	PPAF	\$0.08	(see above)	Plug/liner	Qt	(see above)
Dianthus Early Bird™ Frosty ('WP10 VEN06')	Est. 5 Testing	Rights Asserted	\$0.08	(see above)	Plug/liner	Qt	(see above)
Dianthus Early Bird™ Radiance ('WP09 MAR05')	Est. 5 Testing	PPAF	\$0.08	(see above)	Plug/liner	Qt	(see above)
Dianthus Early Bird™ Sherbet ('WP08 NIKI03')	Est. 5 Testing	PPAF	\$0.08	(see above)	Plug/liner	Qt	(see above)
<b>Dianthus "Scent First"™ Series</b>							
Dianthus Scent First™ Candy Floss ('Devon Flavia')	5	15,903	\$0.08	Containers, borders, mass landscape planting, cut flowers.	Plug/liner	QT, GL, larger	8-10 weeks (Qt) 10-16 weeks (GL)
Dianthus Scent First™ Eternity ('WP05 PP22')	5	PPAF	\$0.08	(see above)	Plug/liner	QT, GL, larger	(see above)
Dianthus Scent First™ Passion ('WP Passion')	5	20,440	\$0.08	(see above)	Plug/liner	QT, GL, larger	(see above)
Dianthus Scent First™ Tickled Pink ('Devon PP11')	5	14,919	\$0.08	(see above)	Plug/liner	QT, GL, larger	(see above)

# PlantHaven Variety Guide - 2010 (Continued)

Variety	Zone	Patent	Royalty	Uses	Availability	Pot Size	Approx. Finish Times
<b>Dianthus "Star"™ Series</b>							
Dianthus Star Pop Star ('Devon Esther')	5	18,222	\$0.08	Containers, borders, mass landscape planting.	Plug/liner	QT, GL, larger	(see above)
<b>Dianthus "Surprise"™ Series</b>							
Dianthus Surprise™ Coconut Surprise ('WP05 YVES')	5	18,828	\$0.08	Containers, borders, mass landscape planting, cut flowers.	Plug/liner	QT, GL, larger	6-8 weeks (Qt) 10-12 weeks (GL)
Dianthus Surprise™ Raspberry Surprise ('Devon Yolande')	5	16,029	\$0.08	(see above)	Plug/liner	QT, GL, larger	(see above)
Erysimum Fragrant Star ('Walfrastar')	7	Rights Asserted	\$0.15	Containers, beds, borders, landscape planting.	Plug/liner	QT, GL, larger	4-6 weeks (Qt) 8-10 weeks (GL)
Euphorbia 'Ascot Rainbow'	5b	PPAF	\$0.25	Pots & containers, summer border, modern courtyard.	URCs, plug/liner	QT, GL, larger	6-8 weeks (Qt) 10-12 weeks (GL)
Gaillardia 'Fanfare Blaze' (G711)	4 Est. 5 Testing	Rights Asserted	Exp.	Containers, beds, borders.	Plug/liner	QT, GL, larger	(see above)
Gaura 'Passionate Rainbow Petite'	7	Rights Asserted	\$0.13	Containers, beds, borders, landscape planting.	URCs, plug/liner	QT, GL, larger	4-6 weeks (Qt) 8-10 weeks (GL)
Geranium Crystal Rose ('ABPP')	5	18,222	\$0.25	(see above)	URCs, plug/liner	QT, GL, larger	8-10 weeks (Qt) 10-12 weeks (GL)
Phormium 'Jubilee'	8	19,059	\$0.50	Containers, beds, borders, landscape planting.	Plug/liner	QT, GL, larger	12-24 weeks (Qt) 24-36 weeks (GL)
Sedum 'Elsie's Gold'	3	20,368	\$0.25	(see above)	URCs, plug/liner	QT, GL, larger	6-8 weeks (Qt) 10-12 weeks (GL)
Tibouchina Groovy Baby ('Teko')	10	Rights Asserted	\$0.15	(see above)	URCs, plug/liner	QT, GL, larger	(see above)

# Plant

# Source

Abutilon Lucky Lantern Tangerine (#7) 5, 16  
Abutilon Lucky Lantern White ('Abut602') 5, 16  
Abutilon Lucky Lantern Yellow ('Abut603') 5, 16  
Agapanthus 'Gold Strike' 2, 13  
Colocasia 'Diamond Head' 1, 10, 11, 13, 16  
Cordyline 'Design a Line Burgundy' 13  
Cordyline Renegade ('Tana') 13, 16, 17  
Dahlia Mystic Enchantment ('Another Pet') 5, 9  
Dahlia Mystic Haze ('Dark Side of the Sun') 5, 9  
Dianthus Early Bird™ Chili ('WP10 SAB06') 8, 18  
Dianthus Early Bird™ Fizzy ('WP08 VER03') 8, 18  
Dianthus Early Bird™ Frosty ('WP10 VEN06') 8, 18  
Dianthus Early Bird™ Radiance ('WP09 MAR05') 8, 18  
Dianthus Early Bird™ Sherbet ('WP08 NIKI03') 8, 18  
Dianthus Surprise™ Coconut Surprise ('WP05 YVES') 8  
Dianthus Surprise™ Raspberry Surprise ('Devon Yolande') 8, 12, 13, 14, 18  
Dianthus Scent First™ Candy Floss ('Devon Flavia') 8, 18  
Dianthus Scent First™ Eternity ('WP05 PP22') 8, 18  
Dianthus Scent First™ Passion ('WP Passion') 8, 18  
Dianthus Scent First™ Tickled Pink ('Devon PP11') 8, 18  
Dianthus Star Pop Star ('Devon Esther') 7, 8, 10, 12, 18  
Erysimum Fragrant Star ('Walfrastar') 3, 4, 8, 13, 18, 20  
Euphorbia 'Ascot Rainbow' 3, 4, 5, 8, 13, 18, 20  
Gaillardia 'Fanfare Blaze' (G711) 5, 13  
Gaura 'Passionate Rainbow Petite' 5, 8  
Geranium Crystal Rose ('ABPP') 3, 5, 7, 13  
Phormium 'Jubilee' 6  
Sedum 'Elsie's Gold' 4, 8, 12, 13, 18  
Tibouchina Groovy Baby ('Teko') 13, 16

1 Agristarts  
2 Ball Horticulture Company  
3 Creek Hill Nursery  
4 Emerald Coast Growers  
5 Florexpo S.A. (Brokers: McGregor, McHutchison)  
6 Foxtail Farms  
7 GET Group, Inc.  
8 Green Leaf Plants  
9 GroLink Plant Company, Inc.  
10 James Greenhouses  
11 Jolly Farmer Products  
12 Northwest Horticulture  
13 Pacific Plug & Liner  
14 Pioneer Gardens, Inc.  
15 Pleasant View Gardens, Inc.  
16 Plug Connection  
17 Rancho Tissue Technologies, Inc.  
18 Skagit Gardens, Inc.  
19 Walla Walla Nursery  
20 Walters Gardens, Inc.

PlantHaven® is an independent breeder's agency. **We do not produce these varieties.** Varieties shown are from breeders we represent and have been licensed to growers for propagation. The patented cultivars presented here originate from U.S. and International Breeders and are available from a variety of licensed propagators or distributors. If you would like to participate in the PlantHaven program, as a propagator, a grower, a retailer or a landscaper, we would be pleased to hear from you!

Above listings reflect planned availability for Fall 2010 or sooner. Subject to change. Contact your broker for most current suppliers. ©2010 PlantHaven®, Inc. All rights reserved. PlantHaven® and From Breeder to Market® are registered trademarks of PlantHaven, Inc.



PO Box 3056 • Santa Barbara, CA 93130-3056 USA  
PH: (805) 569-9179 • FAX: (805) 569-6549  
E-mail: new.plants@planthaven.com

[www.planthaven.com](http://www.planthaven.com)